

# **Lazada Integration for Magento 2 Guide 0.0.1**

by CedCommerce Docs - Products User Guides

<b>1. Overview .....</b>	<b>3</b>
<b>2. Lazada Integration for Magento 2 Extension Installation .....</b>	<b>3</b>
<b>3. Manage Apps .....</b>	<b>4</b>
<b>4. Lazada Configuration Settings .....</b>	<b>9</b>
<b>5. Manage Lazada Profiles .....</b>	<b>14</b>
5.1. Add A New Profile .....	14
5.2. Edit the Existing Profile .....	18
5.3. Submit Bulk Action on the Selected Profiles .....	20
<b>6. Lazada Product Listing .....</b>	<b>23</b>
6.1. View/Edit the Lazada Products .....	24
6.2. Submit Bulk Action on the Selected Products .....	25
<b>7. Manage Lazada Orders .....</b>	<b>28</b>
<b>8. Lazada Feeds .....</b>	<b>30</b>
<b>9. Lazada Cron Details .....</b>	<b>34</b>
<b>10. View Lazada Category Details .....</b>	<b>35</b>
<b>11. View Lazada Category Attributes Details .....</b>	<b>36</b>
<b>12. Knowledge base .....</b>	<b>37</b>
<b>13. Help and Support .....</b>	<b>38</b>

## 1. Overview

As an e-commerce continues to grow in Thailand, the Lazada marketplace offers the opportunities to both the new and the experienced sellers to reach new markets, benefit from Lazada support in advertising their goods and monitor critical data on how their store is performing.

With more than 4.5 million daily visits to its sites and close to 100 per cent geographical distribution coverage, Lazada has become the clear choice for sellers throughout Southeast Asia.

The Lazada Integration for Magento 2 helps the Magento® 2 store owners to boost their business and generate the revenue as it interacts with Lazada API's to connect the Magento® 2 stores to Lazada. It provides an opportunity to cover a wide range of customers.

Admin gets an authority to create Lazada Categories and the dependent attributes on the Magento 2 store. It also enables you to establish a mapping of the desired product category on the Magento 2 store for automatic submission of the selected product to the same category on Lazada.com.

This extension interacts with the Lazada Marketplace to integrate the synchronized product listing between Magento® 2 and the Lazada.com retailers.

It enables the admin to manage the Lazada orders on the seller's Magento® 2 stores without making any significant changes to operational functionalities.

Synchronizing orders, products, pricing, and inventory is possible through establishing the communication between Lazada APIs and the Magento® 2 store.

### *Key Features are as follows:*

- **Product Upload Based on Profile:** Enables the admin to create a profile based on single category, and then assign the products to the profile to automate the product upload.
- **Magento Order creation:** The newly placed orders on Lazada.com are automatically created in the Magento® 2 store with all the required details as it is on Lazada.com.
- **Product Data Validation:** The extension enables validating the product information in accordance with Lazada standard and values.
- **Bulk upload Methodology:** Admin gets the authority to upload bulk products on Lazada but just selecting the products and upload in one go.
- **Auto synchronization:** Auto synchronization of the product listing, order, inventory, return and refund, and pricing at regular intervals is established between Magento® 2 and Lazada.com.
- **Bulk upload Methodology:** Admin gets the authority to upload bulk products on Lazada but just selecting the products and upload in one go.
- **Email Notification:** Admin receives the notification through the mail on new order creation, low stock and if the product is rejected from Lazada.
- **Auto-shipment procedure:\*** Provides admin an ability to automatize process of shipment with Shipstation, Shipwork, Stamps.com, Linnworks, Xtento, Shiprush.
- **Product category mapping:** Follows many-to-one category mapping philosophy. Admin can map many categories of the Magento® 2 stores to the single category of Lazada.

## 2. Lazada Integration for Magento 2 Extension Installation

### *To install the Lazada Integration and LazadaAuth Extension-*

1. Log in the **ftp**, and then go to Magento 2 root folder (generally present under the [public\\_html](#) folder).
2. To install the SDK, create a new folder named cedcross inside the vendor directory **Upload or Drag and**

Drop `lazada-sdk` inside the `vendor/cedcross/` directory, and add the below line in Magento root `composer.json` file in `autoload psr-4` section:

`"Lazada\\Sdk\\": "vendor/cedcross/lazada-sdk/src/"`

```

    "sebastian/phpcpd": "~3.0.0",
    "squizlabs/php_codesniffer": "~3.5.4"
  },
  "conflict": {
    "gene/bluefoot": "*"
  },
  "autoload": {
    "psr-4": {
      "Magento\\Framework\\": "lib/internal/Magento/Framework/",
      "Magento\\Setup\\": "setup/src/Magento/Setup/",
      "Magento\\": "app/code/Magento/",
      "Zend\\Mvc\\Controller\\": "setup/src/Zend/Mvc/Controller/",
      "Lazada\\Sdk\\": "vendor/cedcross/lazada-sdk/src/"
    }
  },
  "psr-0": {
    "": [
      "app/code/",
      "generated/code/"
    ]
  },
  "files": [
    "app/etc/NonComposerComponentRegistration.php"
  ]
}
```

3. Create a new folder named `code` under the `app` folder; under the `code` folder, create a folder named `Ced`.
  - Upload or Drag and Drop `app/code/Ced/Lazada` directory and Upload or Drag and Drop `app/code/Ced/LazadaAuth` directory. For installing the integrator, upload or drag and drop `app/code/Ced/Integrator`
  - After successfully uploading the directory, the extension will be installed/upgraded.
  - Now run the following upgrade command in cmd
 

```
php bin/magento setup:upgrade
```

```
php bin/magento setup:di:compile
```
  - After upgrade deploy static content:
 

```
php bin/magento setup:static-content:deploy-f
```

### 3. Manage Apps

To begin with, this setting a Lazada seller needs to create an app on the Lazada seller panel.

- Go to the Lazada Seller Panel by clicking on this link([https://sellercenter.lazada.com.ph/apps/seller/login?redirect\\_url=https%3A%2F%2Fsellercenter.lazada.com.ph%2F](https://sellercenter.lazada.com.ph/apps/seller/login?redirect_url=https%3A%2F%2Fsellercenter.lazada.com.ph%2F))
- Enter the authentication details here:

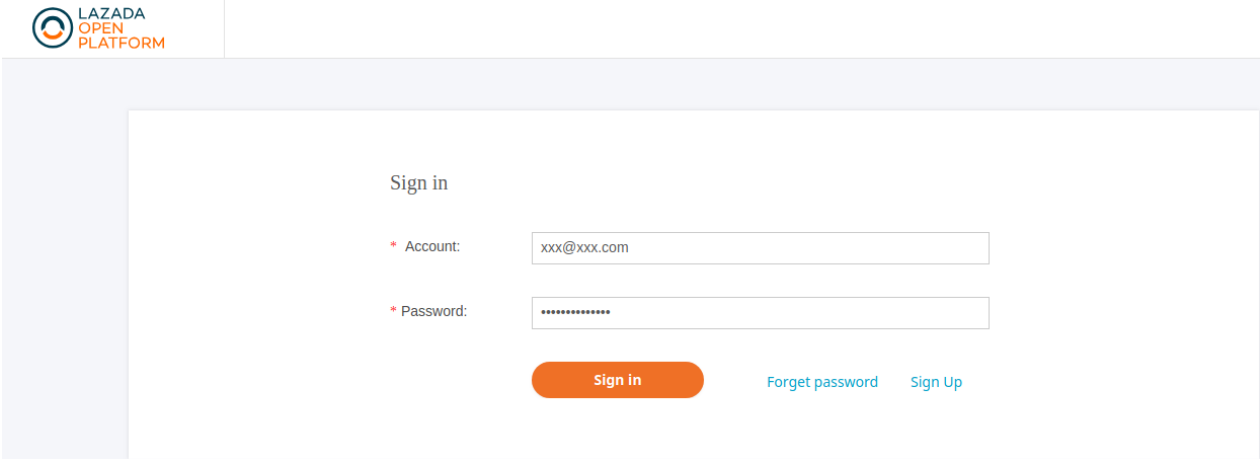

LAZADA OPEN PLATFORM

Sign in

\* Account:

\* Password:

[Sign in](#) [Forget password](#) [Sign Up](#)

- A new page opens up as shown below:

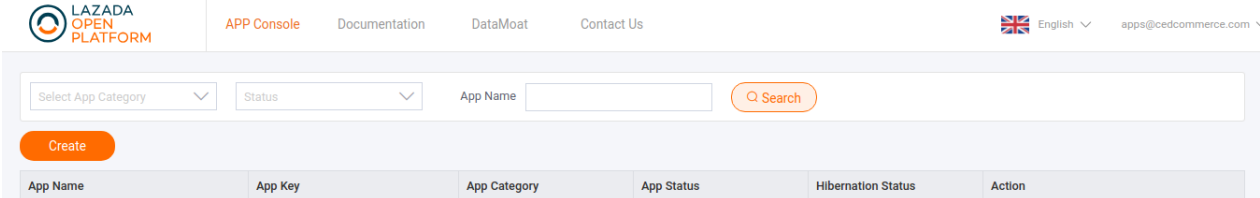

LAZADA OPEN PLATFORM

APP Console Documentation DataMoat Contact Us

English apps@cedcommerce.com

Select App Category Status App Name [Q Search](#)

[Create](#)

App Name	App Key	App Category	App Status	Hibernation Status	Action
----------	---------	--------------	------------	--------------------	--------

- Click on the Create Button again a new page opens up:

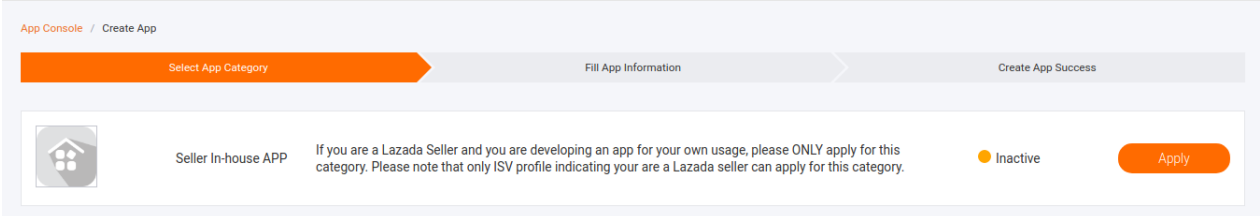

App Console / Create App

Select App Category Fill App Information Create App Success

 Seller In-house APP If you are a Lazada Seller and you are developing an app for your own usage, please ONLY apply for this category. Please note that only ISV profile indicating your are a Lazada seller can apply for this category. Inactive [Apply](#)

- In the Seller In-house APP, click on **Apply**.
- Follow the other instructions and create an app successfully.

### To view and manage apps:

- Go to **Magento Admin Panel**.
- On the left navigation bar, click the **LAZADA INTEGRATION** menu.  
A menu appears as shown in the following figure:

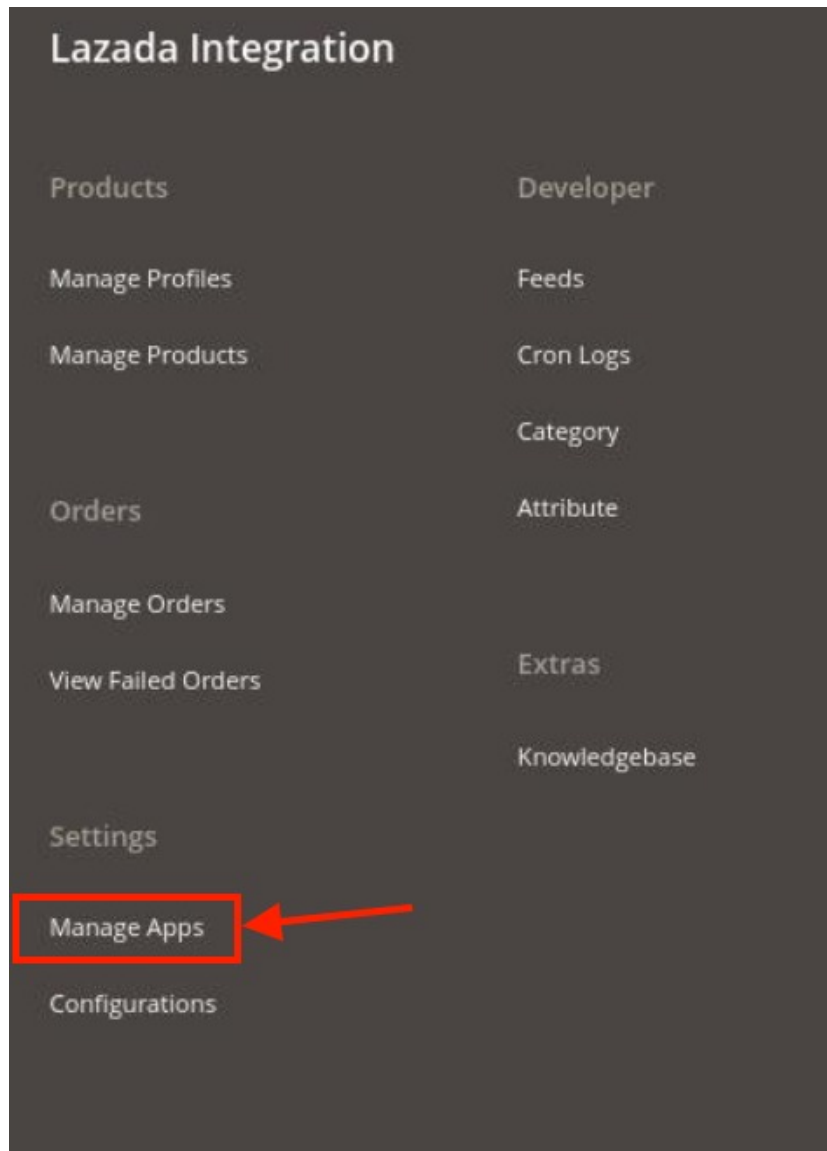

3. Click on **Manage Apps**.

The **Lazada Apps** page appears as shown in the following figure:

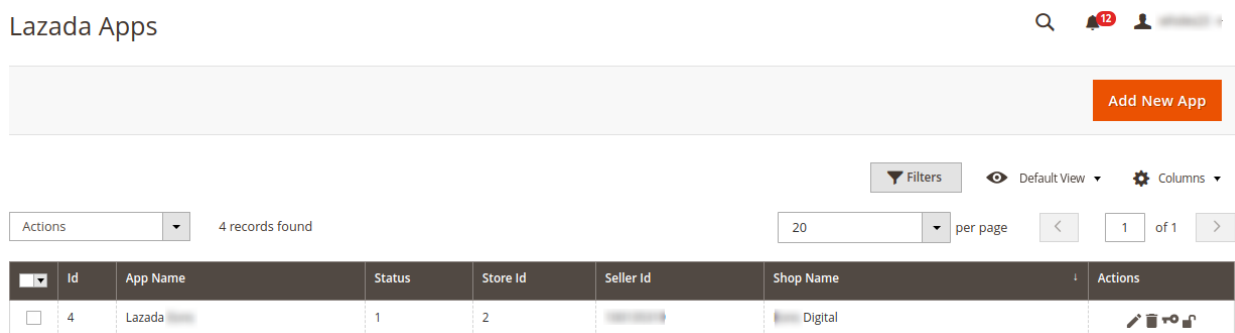

4. All the existing apps are listed on this page.

5. To add a new app, click on the **Add New App** Page on the top right corner button as shown:

## Lazada Apps



Add New App

Filters

Default View

Columns

Actions

4 records found

20 per page

&lt;

1

of 1

&gt;

6. You will be redirected to a new page:

## Add App



← Back

Save

Save and Continue Edit

## App Information

Authorize via Cedcommerce \* ☐ NoRedirect Uri \*  CopyApp Name \* App Key \* App Secret \* 

7. Here you have two options

- a. Authorize via CedCommerce
- b. Authorize yourself

8. While choosing to **Authorize via CedCommerce**, Choose **Yes**.Authorize via Cedcommerce \* ☒ YesApp Name \* 9. You only have to enter the **App Name** and in the **App installation** column enter the code provided by CedCommerce and install.10. But if you wish to authorize it by yourself, you can easily do so by selecting **No** in **Authorize via CedCommerce**.

11. A few additional menu opens up as shown below:

## App Information

Authorize via Cedcommerce \* ☐ No

Redirect Uri \*  [Copy](#)

App Name \*

App Key \*

App Secret \*

Store ⌵

App Installation ⌵

App Tokens ⌵

12. Enter the **App Name** in the first column under App Information.

- The **App Key** and **App Secret Key** can be easily retrieved from the Lazada seller panel.
- To retrieve the keys, Go to the Lazada seller panel:

LAZADA OPEN PLATFORM

APP Console Documentation DataMoot Contact Us

Select App Category  Status  App Name  [Search](#)

[Create](#)

App Name	App Key	App Category	App Status	Hibernation Status	Action
CedCommerce Lazada Integration		ERP System	Test	No	<a href="#">Manage</a>

- By clicking on Manage you will be redirected to the basic information page:

Advanced Information [?](#)

App Category	ERP System
App Key	
App Secret	
App Status	Test <a href="#">Apply Online</a>

[Hide](#) [Reset](#)

- Under the advanced information, both the App Key and the App Secret Key are mentioned.

13. Now move back to your Magento panel.

14. Under the store option, choose the **Default Store** for your **Lazada Integration Extension**.

15. You can cut all the chase if you have the **App Code** which is to be entered in the App Installation.

## App Installation

By Code  [Install](#)



16. Now click on **Save and Continue** and the **Apps** settings are saved.

## 4. Lazada Configuration Settings

Once the extension is successfully installed in the Magento 2 store, the **LAZADA INTEGRATION** menu appears on the left navigation bar of the Magento 2 Admin panel. The merchant has to first create a seller account in the Lazada seller panel. Once the seller account is created and is approved by Lazada, then the Magento 2 store owners can use the Lazada **API credentials provided by Lazada** while setting up the Lazada Configuration settings in the **Magento 2 Admin** panel.

### *To set up the configuration settings in the Magento 2 Admin panel*

1. Go to the **Magento 2 Admin** panel.
2. On the left navigation bar, click the **LAZADA INTEGRATION** menu.  
The menu appears as shown in the following figure:

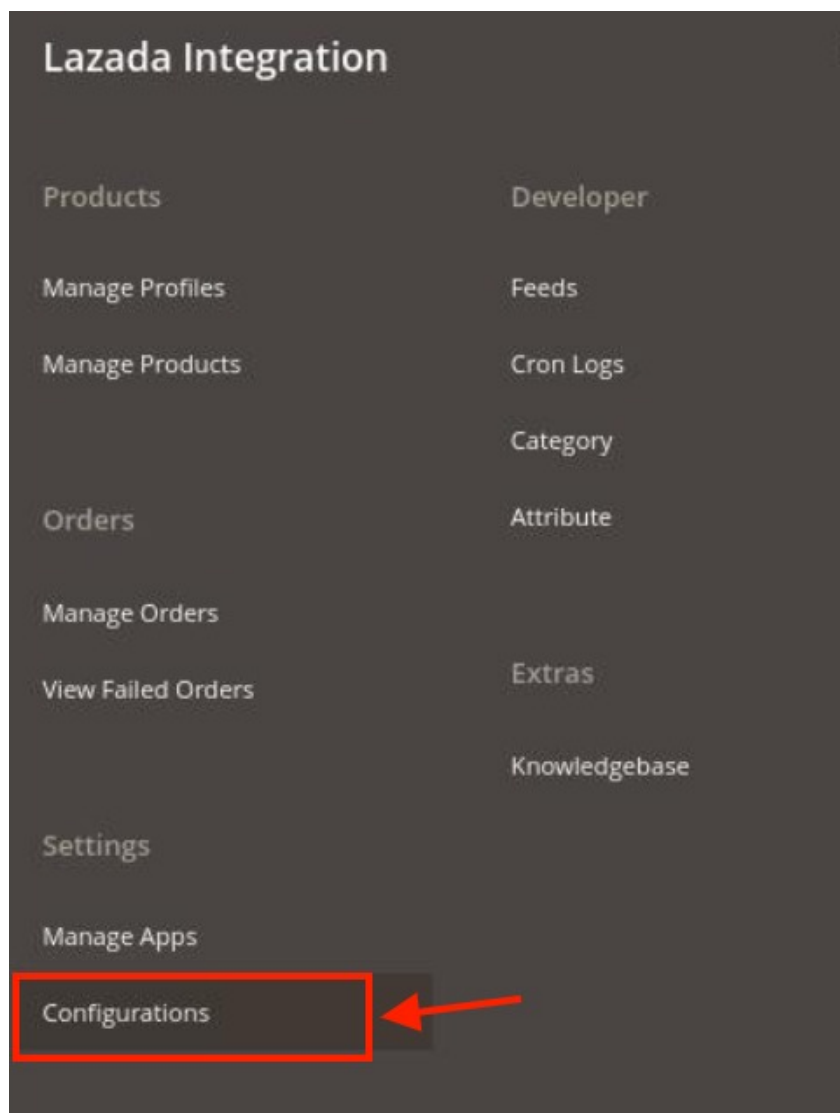

3. Click **Configuration**.  
The **Configuration** page appears as shown in the following figure:

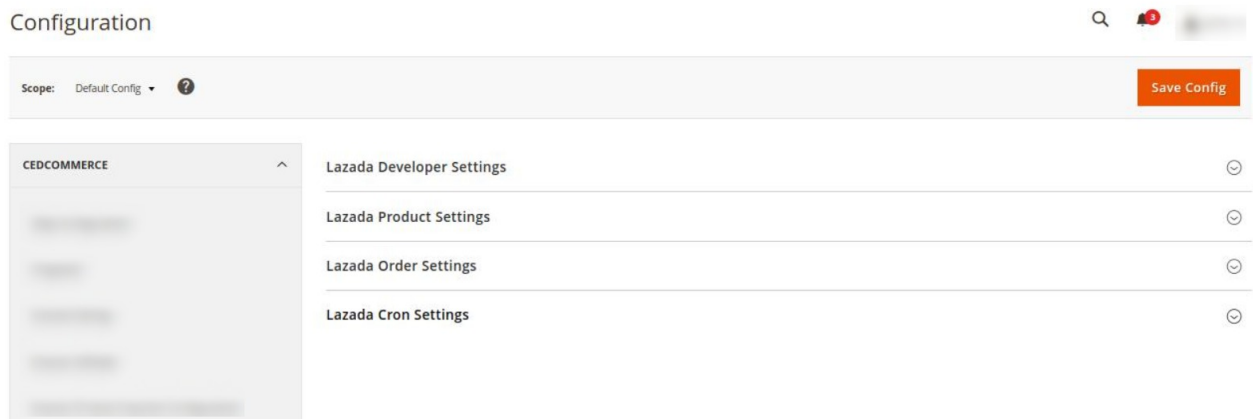

4. In the right panel, click the **Lazada Developer Settings** tab.  
The **Lazada Seller/Developer Settings** tab is expanded and the relevant fields appear as shown in the following figure:



5. Under **Lazada Developer Settings**, do the following steps:
  - a. In the **Debug**, select **Yes** for enabling the debugging.
6. Click the **Save Config** button to save the entered values.
7. Scroll down to the **Lazada Product Settings** tab, and then click the tab.  
The **Lazada Product Settings** tab is expanded and the expanded section appears as shown in the following figure:

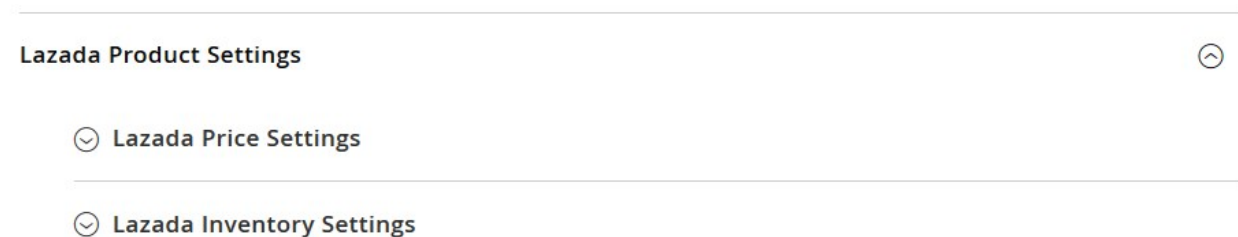

8. Under **Lazada Product Settings**, do the following steps:
  - a. Click the **Lazada Price Settings** tab.  
The **Lazada Price Settings** tab is expanded and the section appears as shown in the following figure:

## Lazada Product Settings



## Lazada Price Settings

Product Price [global] Default Magento Price

Select to send a different product price to **Lazada**

Include Taxes [global] Yes

Add taxes to product price to be sent to **Lazada**

b. Under **Lazada Price Settings**, do the following step:

i. In the **Product Price** list, select one of the following options:

**Increase by Fixed Price:** If selected, then the **Modify by Fix Price** field appears.

**Increase by Fixed Percentage:** If selected, then the **Modify by Percentage Price** field appears.

Enter the numeric value to increase the price of the Lazada, product price by the entered value % of Magento 2 price.

## Lazada Price Settings

Product Price [global] Increase By Fixed Percentage

Select to send a different product price to **Lazada**

Modify by Percentage Price [global] 5

Numeric value Required for **Add/subtract % on Magento price** 5 for Example: Magento price +/- 5% of Magento price.

*For Example,*

Magento 2 price + 5% of Magento 2 price.

Magento 2 Price = 100

Select **Increase By Fixed Percentage** option

**Modify by Percentage Price** = 5

$100 + 5\% \text{ of } 100 = 100 + 5 = 105$

Thus, Lazada Product Price = 105

**Decrease by Fixed Price:** If selected, then the **Modify by Fix Price** field appears.

**Decrease by Fixed Percentage:** If selected, then the **Modify by Percentage Price** field appears.

Enter the numeric value to decrease the price of the Lazada product price by the entered value % of Magento 2 price

*For Example,*

Magento 2 price – 5% of Magento 2 price.

Magento 2 Price = 100

Select **Decrease By Fixed Percentage** option

**Modify by Fix Price** = 5

$100 - 5\% \text{ of } 100 = 100 - 5 = 95$

Thus, Lazada Product Price = 95

ii. In **Include Taxes**, select Yes if you want to add the tax to the product.

c. Click the **Lazada Inventory Settings** tab.

The **Lazada Inventory Settings** tab is expanded and the section appears as shown in the following figure:

## ⌵ Lazada Inventory Settings

Set Inventory on Basis of Threshold [global]  

Choose yes to send inventory on lazada by condition

- d. Under the **Lazada Inventory Settings** tab, do the following steps:
- In the **Set Inventory on Basis of Threshold** list, select the **Enable** option if required to set the inventory based on a threshold.  
**Note:** Only when the admin selects **Enable**, the other fields appear. Threshold Inventory is the minimum count of an item that the store owner wants to keep in stock. The section appears as shown in the following figure:

## ⌵ Lazada Inventory Settings

Set Inventory on Basis of Threshold [global]  

Choose yes to send inventory on lazada by condition

Inventory Threshold Value [global]

Set inventory quantity on which lesser and greater condition can control.

Send Inventory for Lesser Than Threshold Case [global]

Send Quantity to Lazada for those products, whose inventory is LESSER than the inventory threshold.

Send Inventory for Greater Than Threshold Case [global]

Send Quantity to Lazada for those products, whose inventory is GREATER than the inventory threshold.

- In the **Inventory Threshold Value** box, enter the required value.
  - In the **Send Inventory for Lesser Than Threshold Case** box, enter the required value.
  - In the **Send Inventory for Greater Than Threshold Case** box, enter the required value.
- Click the **Save Config** button to save the entered values.
  - Scroll down to the **Lazada Order Settings** tab, and then click the tab.  
The tab is expanded and the section appears as shown in the following figure:

## Lazada Order Settings

**Lazada Order Id Prefix** [global]

Prefix for Lazada Increment ID

**Auto invoice imported order** [global]

Auto Invoice Order Imported from Lazada in any case of successfull import.

**Auto cancel failed order** [global]

Auto Cancel Order on Lazada in any case of failure such as 'No Inventory'.

**Enable Default Customer** [global]

**Default Customer** [global]

**Delivery Type** [global]

**Enable Notification** [global]

Order import notification via email to store admin

11. Under **Lazada Order Settings**, do the following steps:

- In the **Lazada Order Id Prefix** box, enter the required order Id prefix.
- In **Auto Invoice Imported Order**, select **Enable** if want the automatic invoice for orders imported from Lazada.
- In **Auto Cancel Failed Order**, select **Enable** if you want to cancel the failed orders automatically.
- In the **Enable Default Customer** list, select the **Yes** option to enable the default customer.  
The field appears as shown in the following figure:

**Default Customer** [global]

- In the **Default Customer** list, select the required customer name.
- In **Delivery Type**, select the type of delivery of the product.
- In the **Enable Notification** box, select **Enable** to receive order import notifications.

12. Click the **Save Config** button to save the entered values.

13. Scroll down to the **Lazada Cron Settings** tab, and then click the tab.

The tab is expanded and the section appears as shown in the following figure:

## Lazada Cron Settings

**Order Cron** [global]

Order Fetch Cron

**Inventory|Price Cron** [global]

Inventory Sync Cron

14. Under **Lazada Cron Settings**, do the following steps:

- In the **Order Cron** list, select **Enable** to enable the fetch order cron.

- b. In **Order Status Sync Cron**, select **Enable** to synchronize the lazada order status.
  - c. In the **Inventory |Price Cron** list, select **Enable** to enable the Inventory & Price Sync cron.
15. Click the **Save Config** button to save the entered values.

## 5. Manage Lazada Profiles

Admin can create a new profile and assign the required products to the profile. While creating and editing the profile, admin can map the Magento 2 attributes to the Lazada attributes. These attributes are applicable to all the products that are assigned to the profile.

### *Admin can do the following tasks:*

- Add new profile(<https://docs.cedcommerce.com/magento-2/lazada-magento-2-integration-guide-0-0-1?section=add-a-new-profile-20>)
- Edit the existing profile(<https://docs.cedcommerce.com/magento-2/lazada-magento-2-integration-guide-0-0-1?section=edit-the-existing-profile-30>)
- Bulk Action on the Selected Profiles(<https://docs.cedcommerce.com/magento-2/lazada-magento-2-integration-guide-0-0-1?section=submit-bulk-action-on-the-selected-profiles>)

### 5.1. Add A New Profile

#### *To add a new profile*

1. Go to the **Magento 2 Admin** panel.
2. On the left navigation bar, click the **LAZADA INTEGRATION** menu.

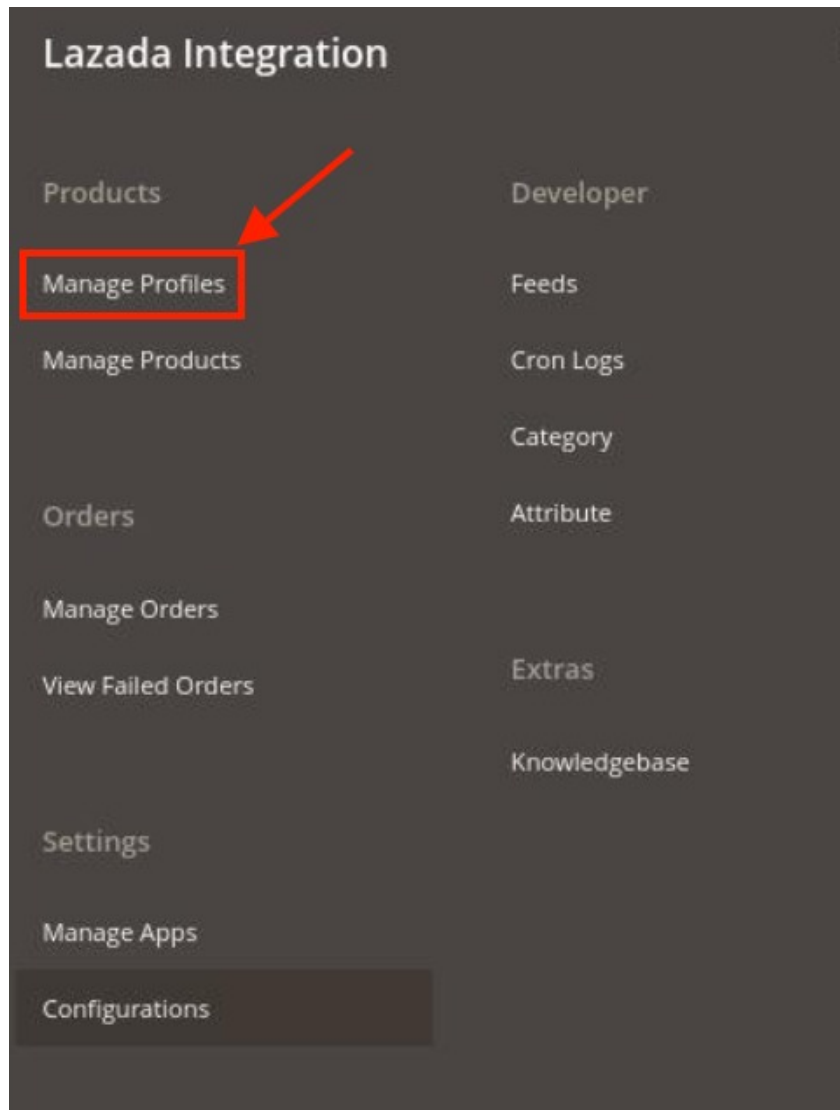

3. Click on **Profile Manager**.

The **Manage Profile** page appears as shown in the following figure:

Manage Profile
Add New Profile

Filters
Default View
Columns

Actions
1 records found
20 per page
1 of 1

	ID	Profile Code	Profile Name	Status	Action
<input type="checkbox"/>	2	lazada	Lazada	Enabled	<a href="#">Edit</a>

4. Click the **Add New Profile** button.

**Note:** Please create an app first then the admin will be able to create the profile.

The **New Profile** page appears as shown in the following figure:

## Add A New Profile



← Back

Save

Save and Continue Edit

## General Information

Enable Profile ☒ YesProfile Code \* Profile Name \* 

5. Under the **General Information**, do the following steps:

a. In the **Enable Profile**, select **Yes** to enable the profile.

**Note:** Selecting No option disables the profile.

b. In the **Profile Code** box, enter a profile code.

**Note:** It is only for internal use. Use the unique profile code with no spaces. Start with small letters.

c. In the **Profile Name** box, enter the name of the profile.

**Note:** Use the unique name to identify the profile.

6. Now, click the **Profile Mapping** menu.

The page appears as shown in the following figure:

## Profile Mappings



Profile App \*

Lazada Profile Type \*

Profile Regions \*

Profile Category \*

Please map all Lazada attributes with Magento attributes.

Lazada Attribute	Magento Catalog Attribute	Is Secondary Store	Default Value	Action
Add Attribute				

- The user first needs to choose the default application for the profile from the **Profile App** drop-down menu.
- In **Lazada Profile Type**, select the profile type from the menu.
- Now choose the region you choose to sell with this profile from the **Profile Regions**.
- In the **Parent Category** list, select the required category and subcategory from the drop-down menu as shown.



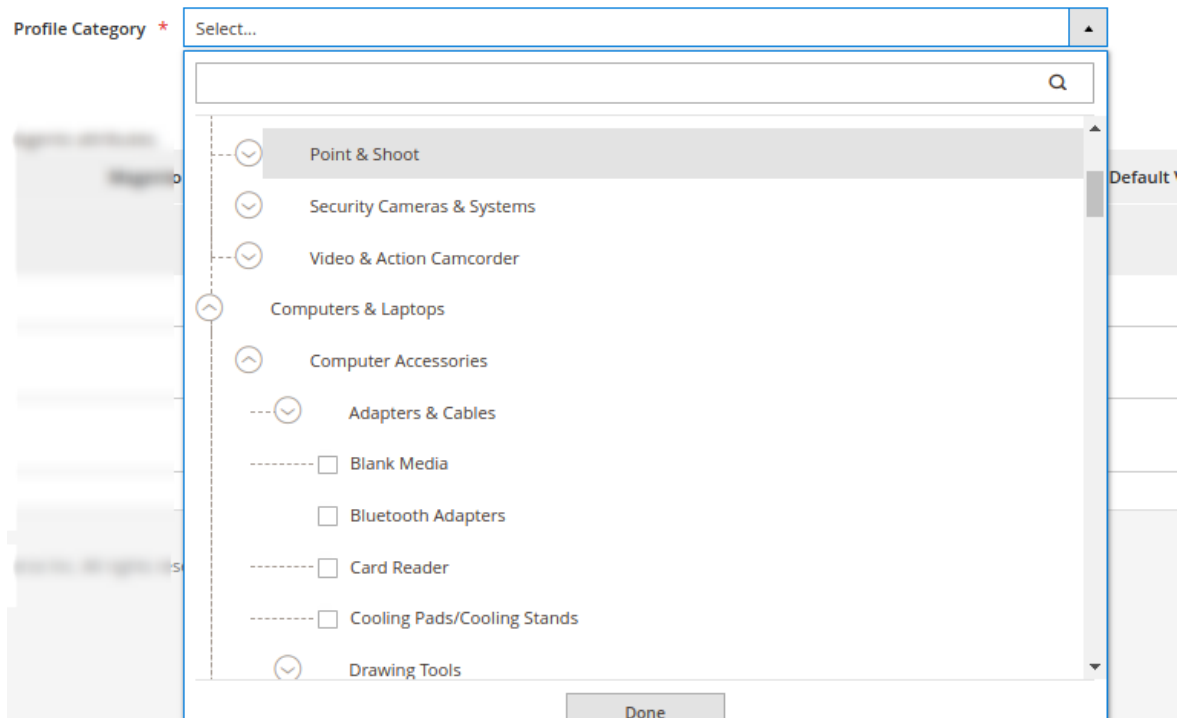

- Then map all the Lazada attributes with the Magento attributes.

7. Scroll down to the **Product Price Rules** and the section expands as:

#### Product Price Rules

Pricing Type \* Not Change

Pricing Value

8. In the **Pricing Type** choose one of the following options:

- **Increase by Fixed Price:** If selected, then the **Modify by Fix Price** field appears.
- **Increase by Fixed Percentage:** If selected, then the **Modify by Percentage Price** field appears.  
Enter the numeric value to increase the price of Lazada, product price by the entered value % of Magento 2 store price.  
*For Example,*  
Magento 2 price + 5% of Magento 2 price.  
Magento 2 Price = 100  
Select **Increase By Fixed Percentage** option  
**Modify by Percentage Price = 5**  
 $100 + 5\% \text{ of } 100 = 100 + 5 = 105$   
Thus, Lazada Product Price = 105
- **Decrease by Fixed Price:** If selected, then the **Modify by Fix Price** field appears.
- **Decrease by Fixed Percentage:** If selected, then the **Modify by Percentage Price** field appears.  
Enter the numeric value to decrease the price of the Lazada product price by the entered value % of Magento 2 store price  
*For Example,*  
Magento 2 price – 5% of Magento 2 price.  
Magento 2 Price = 100

Select **Decrease By Fixed Percentage** option

**Modify by Fix Price** = 5

$100 - 5\% \text{ of } 100 = 100 - 5 = 95$

Thus, Lazada Product Price = 95

9. Enter the Price Value in the next column of **Pricing Value**.

10. Now move to the last section of the profile settings which is the **Profile products**.

Profile Products 

Default Store \*  

Secondary Store \*  

Product Selection \*

Product Addition \*

Search and Add [Reset Filter and Remove](#) 2050 records found  per page  of 103

ID	Profile	Store Category	Name	SKU	Price	Actions
2050	-				\$200.00	<a href="#">Edit</a>
2049	-	Default Category, Sale, What's New			\$66.00	<a href="#">Edit</a>
2048	-	Training			\$7,769.00	<a href="#">Edit</a>
2047	-				\$100.00	<a href="#">Edit</a>

11. Choose the **Default store**, **Secondary store**, **Product Selection**, and **Product Addition**.

12. Now you can easily select the products for the desired profile. You can search the products using id, store category, Name, or SKU.

13. Once all the actions have been taken so far, click on the **Save Config** button on the top right of the page.

14. A new profile will be added.

## 5.2. Edit the Existing Profile

### *To edit the existing profile*

1. Go to the **Magento 2 Admin** panel.
2. On the left navigation bar, click the **LAZADA INTEGRATION** menu.

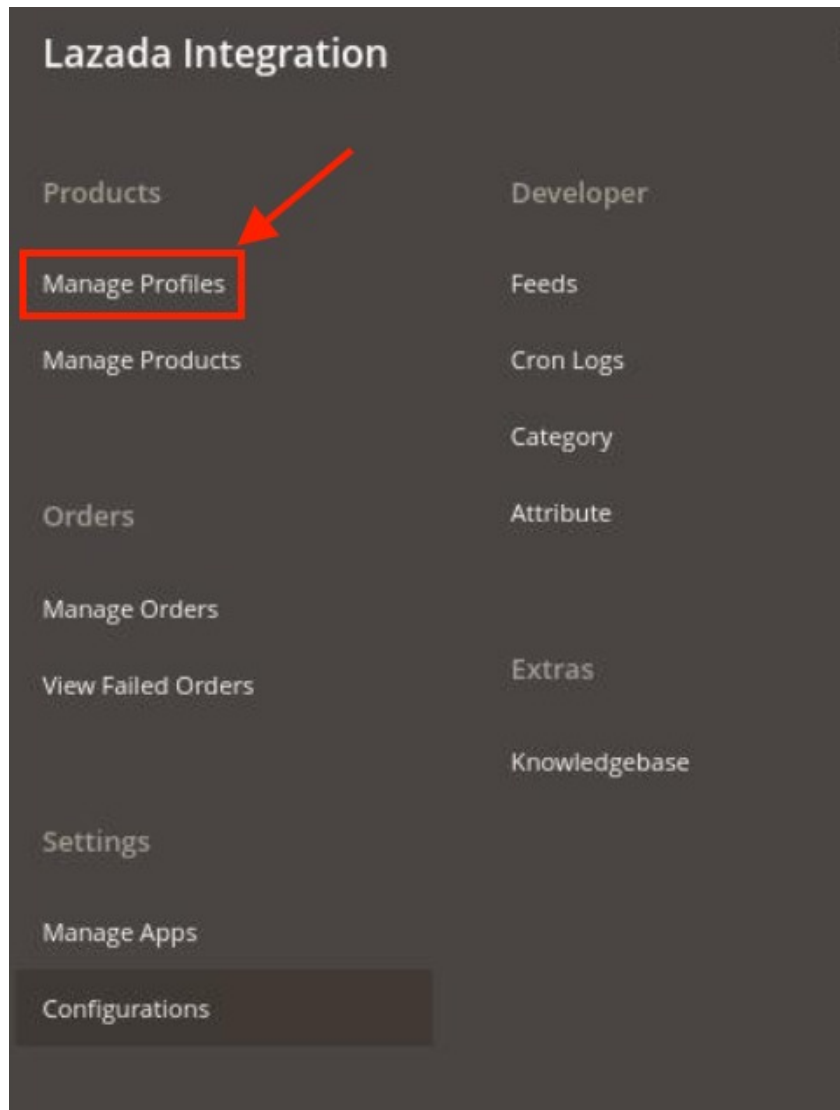

3. Click on **Profile Manager**.

The **Manage Profile** page appears as shown in the following figure:

Manage Profile 🔍 13 👤 lazada ▾

Add New Profile

Filters
👁 Default View ▾
⚙ Columns ▾

Actions ▾
2 records found
20 ▾ per page
< 1 of 1 >

<input checked="" type="checkbox"/>	ID	Profile Code	Profile Name	Status	Action
<input type="checkbox"/>	2	lazada	Lazada	Enabled	<a href="#" style="color: #0070c0;">Edit</a>
<input type="checkbox"/>	3	profilecode2	Profile 2	Enabled	<a href="#" style="color: #0070c0;">Edit</a>

4. Scroll down to the required profile row.

5. In the **Action** column of the respective row, click the **Edit** link.

The profile editing page appears as shown in the following figure:

Edit Profile

← Back Delete Save Save and Continue Edit

General Information

Enable Profile ☒ Yes

Profile Code \*

Profile Name \*

Profile Mappings

Product Price Rules

Profile Products

6. Make the changes as per requirement in the respective section.
7. Click the **Save** button.  
The edited profile is saved and the success message appears on the **Manage Profile** page.

### 5.3. Submit Bulk Action on the Selected Profiles

*To submit the selected action on the selected profiles in Bulk*

1. Go to the **Magento Admin** panel.
2. On the left navigation bar, click the **LAZADA INTEGRATION** menu.

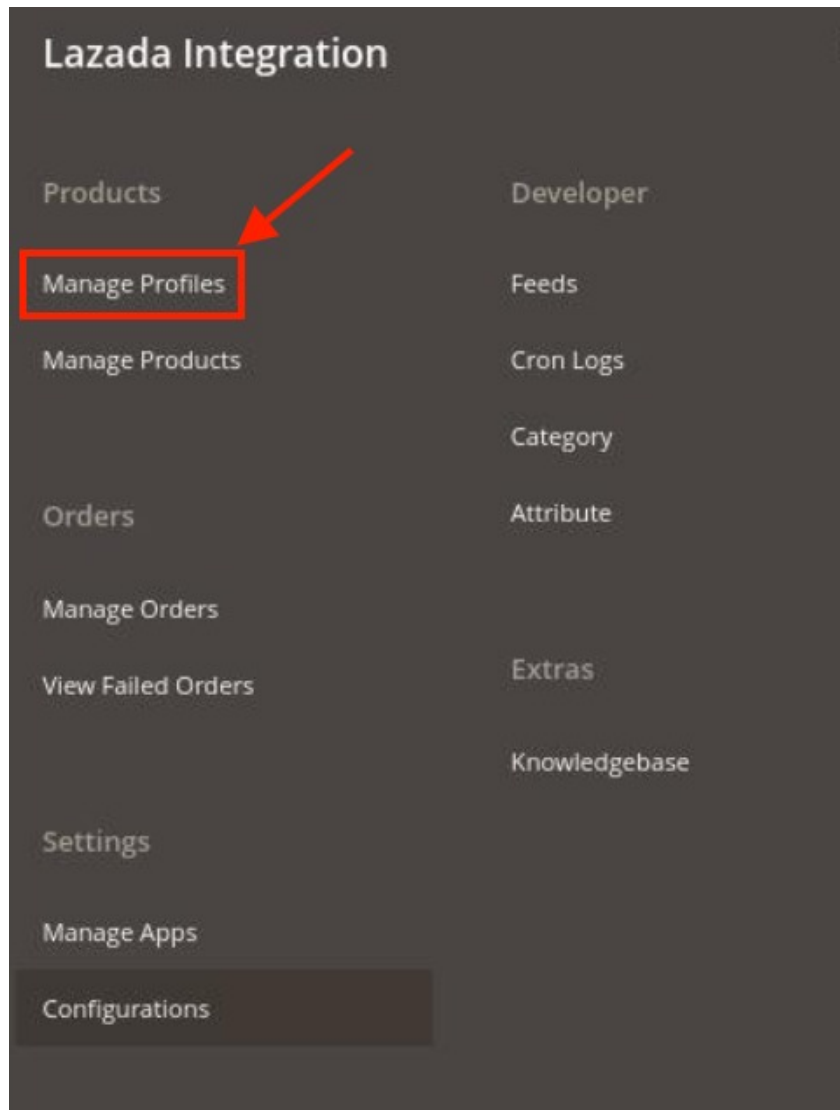

3. Click on **Profile Manager**.

4. The **Manage Profile** page appears as shown in the following figure:

Manage Profile 🔍 13 👤 lazada ▾

Add New Profile

Filters
👁 Default View ▾
⚙ Columns ▾

Actions ▾
2 records found
20 ▾ per page
< 1 of 1 >

<input checked="" type="checkbox"/>	ID	Profile Code	Profile Name	Status	Action
<input type="checkbox"/>	2	lazada	Lazada	Enabled	<a href="#">Edit</a>
<input type="checkbox"/>	3	profilecode2	Profile 2	Enabled	<a href="#">Edit</a>

On this page, all the available profiles are listed.

5. To delete the selected profiles, do the following steps:
  - a. Select the profiles that are no more required.

- b. Click the **Arrow** button next to the **Actions** field.

The **Actions** list appear as shown in the following figure:

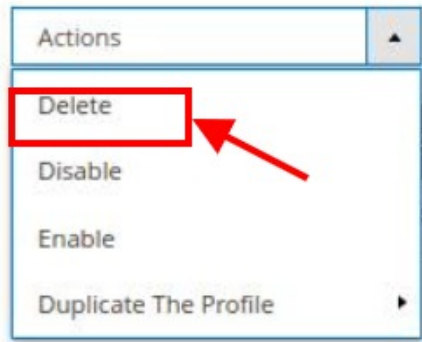

- c. Click the **Delete** option.

A confirmation dialog box appears.

- d. Click the **OK** button.

The selected profiles are deleted.

6. To *disable the selected profiles*, do the following steps:

- a. Select the required profiles.

- b. Click the **Arrow** button next to the **Actions** field.

The **Actions** list appear as shown in the following figure:

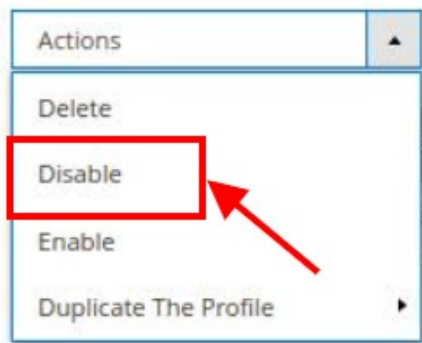

- c. Click the **Disable** option.

The selected profiles are disabled.

7. To *enable the selected profiles*, do the following steps:

- a. Select the required profiles.

- b. Click the **Arrow** button next to the **Actions** field.

The **Actions** list appear as shown in the following figure:

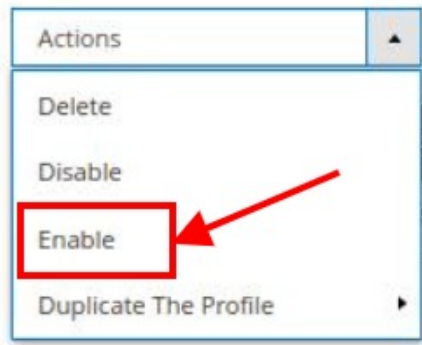

c. Click the **Enable** option.

The selected profiles are enabled.

8. To create duplicate profiles, do the following steps:

a. Select the required profiles.

b. Click the **Arrow** button next to the **Actions** field.

The **Actions** list appear as shown in the following figure:

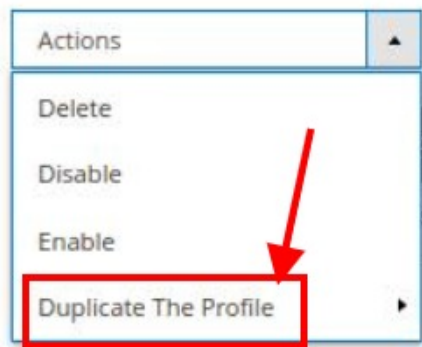

c. Click on the **Duplicate the Profile** option.

The selected profiles are duplicated.

## 6. Lazada Product Listing

On this page, admin can view, edit, and validate the individual product. Also, the admin can view the error message if any error exists in any product details. After uploading the product on Lazada or after updating the product inventory or the product price, the user can check the status of the feed. Also, can view the feed error if any. The admin can also submit certain actions on the selected products available on the **Lazada Product Listing** page.

*This section covers the following topics:*

- Edit the Lazada Products(<https://docs.cedcommerce.com/magento-2/lazada-magento-2-integration-guide-0-0-1?section=edit-the-lazada-products>)
- Submit Bulk Action on the Selected Products(<https://docs.cedcommerce.com/magento-2/lazada-magento-2-integration-guide-0-0-1?section=submit-bulk-action-on-the-selected-products>)

## 6.1. View/Edit the Lazada Products

### *To edit and view the product*

1. Go to the **Magento 2 Admin** panel.
2. On the left navigation bar, click the **LAZADA INTEGRATION** menu.  
The menu appears as shown in the following figure:

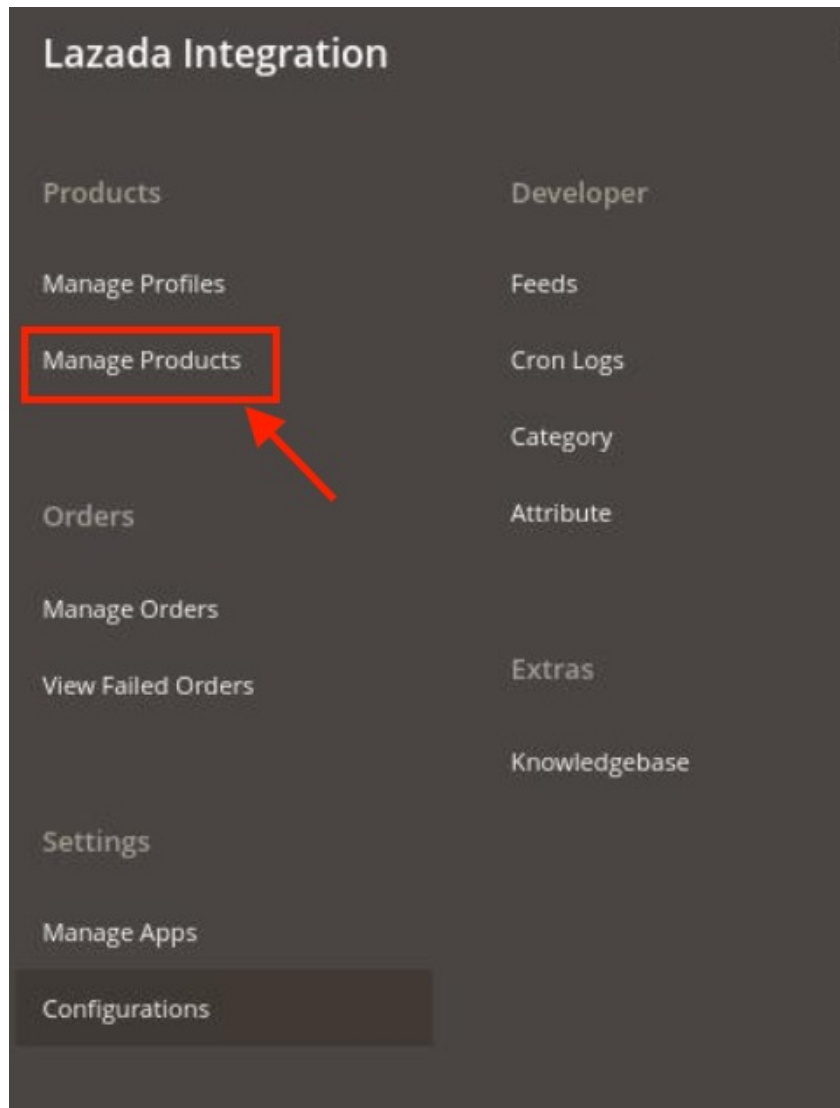

3. Click on **Product Listing**.  
The **Lazada Product Listing** page appears as shown in the following figure:



## Lazada Product Listing

Sync

Actions

33 records found

Filters

Default View

Columns

20









per page

<

1

of 2

>

	ID	Lazada Profile Id	Thumbnail	Name	Type	SKU	Price	Quantity	Visibility	Status	Lazada Status	Validation	Feed	Action	Outer Material	Inner Material	Sole Material
<input type="checkbox"/>	38	FreeKzShop		Summit Watch	Simple Product	24-MG03	\$54.00	100.0000	Catalog, Search	Enabled	ALL NOT UPLOADED	INVALID					
<input type="checkbox"/>	18	FreeKzShop		Pursuit Lumaflex&trade; Tone Band	Simple Product	24-UG02	\$16.00	100.0000	Catalog, Search	Enabled	ALL NOT UPLOADED	NOT VALIDATED					
<input type="checkbox"/>	19	FreeKzShop		Go-Get'r Pushup Grips	Simple Product	24-UG05	\$19.00	100.0000	Catalog, Search	Enabled	ALL NOT UPLOADED	NOT VALIDATED					

4. Scroll down to the required product row.
5. In the **Action** column of the respective row, click the **Edit** icon.  
The product editing page appears.
6. Scroll down to the **Lazada** tab, and then click the tab.  
The tab is expanded and the expanded section appears as shown in the following figure:

Test Product 1
← Back
Add Attribute

**Warranty Type**
[global]

Local Manufacturer Warranty

Please Select type of warranty

**Warranty Period**
[global]

1 Month

Please Select type of warranty

**Lazada Product Image**
[global]

{"VpVpVpp.jpg.jpg":false,"VbVbVbb.jpg":"https://my-live.slatiic.net/originalV66287e"

Lazada Images

**Barcode**
[global]

**Brand**
[global]

Nike

1 to 50 characters

**Lazada Product Status**
[global]

Live

7. Enter the required information, and then click the **Save** button.  
The changes are saved and the success message appears on the **Lazada Product Listing** page.
8. To view product details, click on the **View** button.  
The product will be displayed.

## 6.2. Submit Bulk Action on the Selected Products

**Admin can perform the following tasks through the Bulk Action feature:**

- **Validate Product:** To validate the selected products before uploading to the Lazada website. It displays the corresponding validation error, if any. If there is no error, it confirms that the product is ready to upload.
- **Upload Products:** To validate and upload the selected products to the Lazada website. It displays the corresponding validation error, if any. If there is no error, then the selected products are validated and uploaded, and a success message appears.
- **Update Products:** To update the products edits on Lazada.
- **Update Inventory & Price:** To update the inventory and price of the selected products on Lazada. This action completes the entire job related to the product inventory and also it manages the quantity related issues. *For example*, if the user has changed the product price on the Magento 2 store and also wants to change the price on Lazada then this action is applicable. The price is updated when the user submits this action for the selected product.
- **Delete Products:** Removes the selected products from the Lazada website.

**To submit the selected bulk action on the selected products**

1. Go to the **Magento 2 Admin** panel.
2. On the left navigation bar, click the **LAZADA INTEGRATION** menu.  
The menu appears as shown in the following figure:

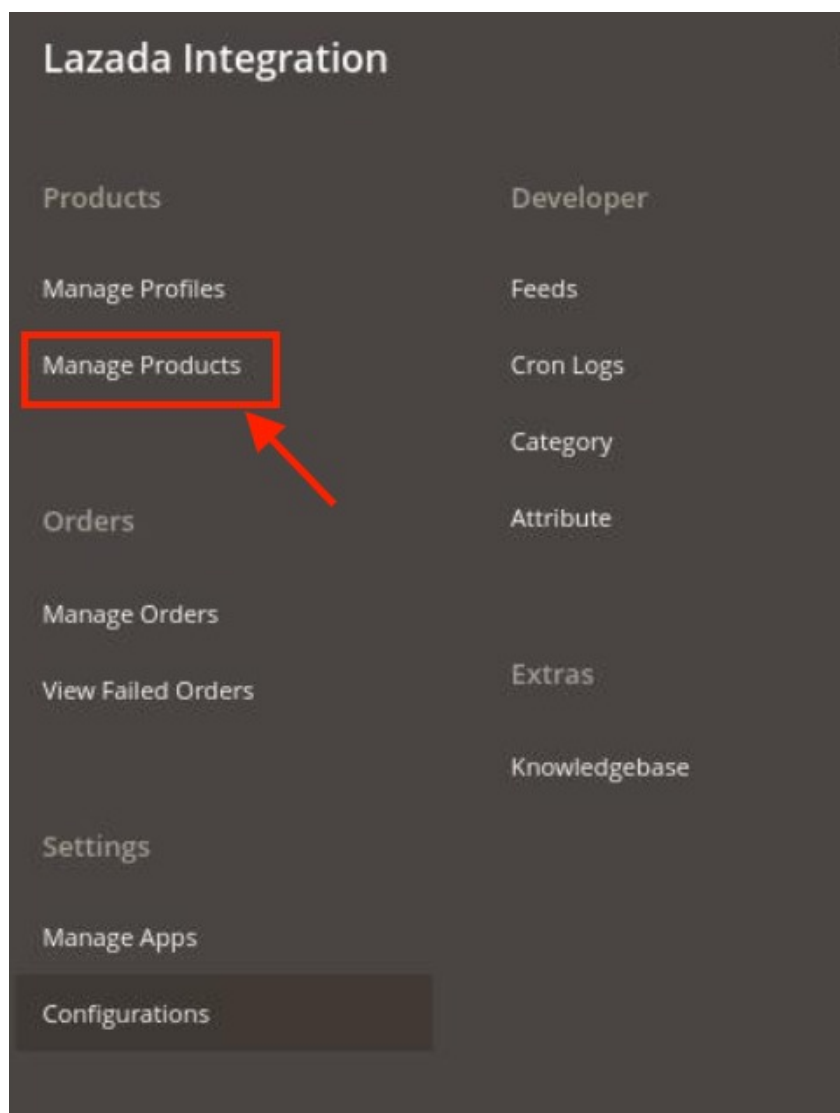

### 3. Click on **Product Listing**.

The **Lazada Product Listing** page appears as shown in the following figure:

Lazada Product Listing

Search 3

Sync

Filters Default View Columns

Actions 33 records found 20 per page 1 of 2

	ID	Lazada Profile Id	Thumbnail	Name	Type	SKU	Price	Quantity	Visibility	Status	Lazada Status	Validation	Feed	Action	Outer Material	Inner Material	Sole Material
<input type="checkbox"/>	38	FreeKzShop		Summit Watch	Simple Product	24-MG03	\$54.00	100.0000	Catalog, Search	Enabled	ALL NOT UPLOADED	INVALID					
<input type="checkbox"/>	18	FreeKzShop		Pursuit Lumaflex&trade; Tone Band	Simple Product	24-UG02	\$16.00	100.0000	Catalog, Search	Enabled	ALL NOT UPLOADED	NOT VALIDATED					
<input type="checkbox"/>	19	FreeKzShop		Go-Get'r Pushup Grips	Simple Product	24-UG05	\$19.00	100.0000	Catalog, Search	Enabled	ALL NOT UPLOADED	NOT VALIDATED					

### 4. To upload the selected products, do the following steps:

- Select the check boxes associated with the required products.
- In the **Actions** list, click the arrow button.

A list appears as shown in the figure:

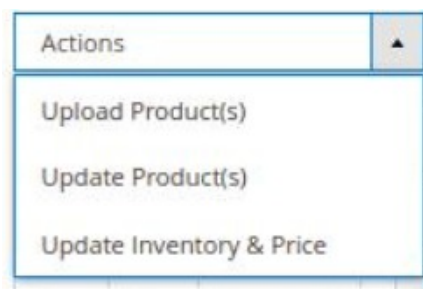

### c. Click **Upload Products**.

A confirmation dialog box appears.

### d. Click the **OK** button.

The selected products are uploaded and a success message appears on the page.

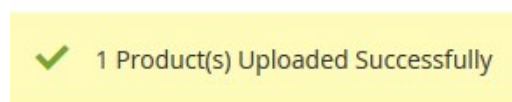

### 5. To update the selected products, do the following steps:

- Select the check boxes associated with the required products.
- In the **Actions** list, click the arrow button.

A list appears as shown in the figure:

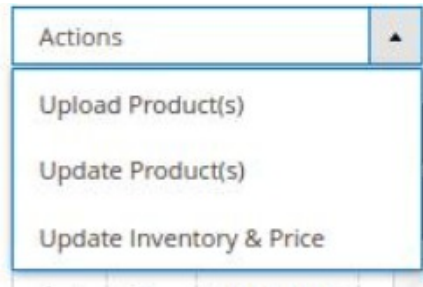

- c. Click **Update Products**.

A confirmation dialog box appears.

- d. Click the **OK** button.

The selected products are updated and a success message appears on the page.

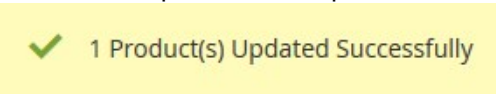

6. To update the inventory and price of the selected products, do the following steps:

- a. Select the checkboxes associated with the required products.

- b. In the **Actions** list, click the arrow button.

A list appears as shown in the figure:



- c. Click on **Update Inventory & Price**.

A confirmation dialog box appears.

- d. Click the **OK** button.

The inventories and the prices of the selected products are updated and a success message appears on the page.

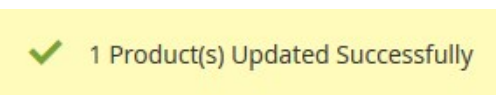

## 7. Manage Lazada Orders

The Magento 2 store owners can fetch the new orders and view all the order details fetched from Lazada. They can also ship the required orders and can delete the orders those are no more required.

### To fetch new orders

1. Go to the **Magento 2 Admin** panel.
2. On the left navigation bar, click the **LAZADA INTEGRATION** menu.  
The menu appears as shown in the following figure:

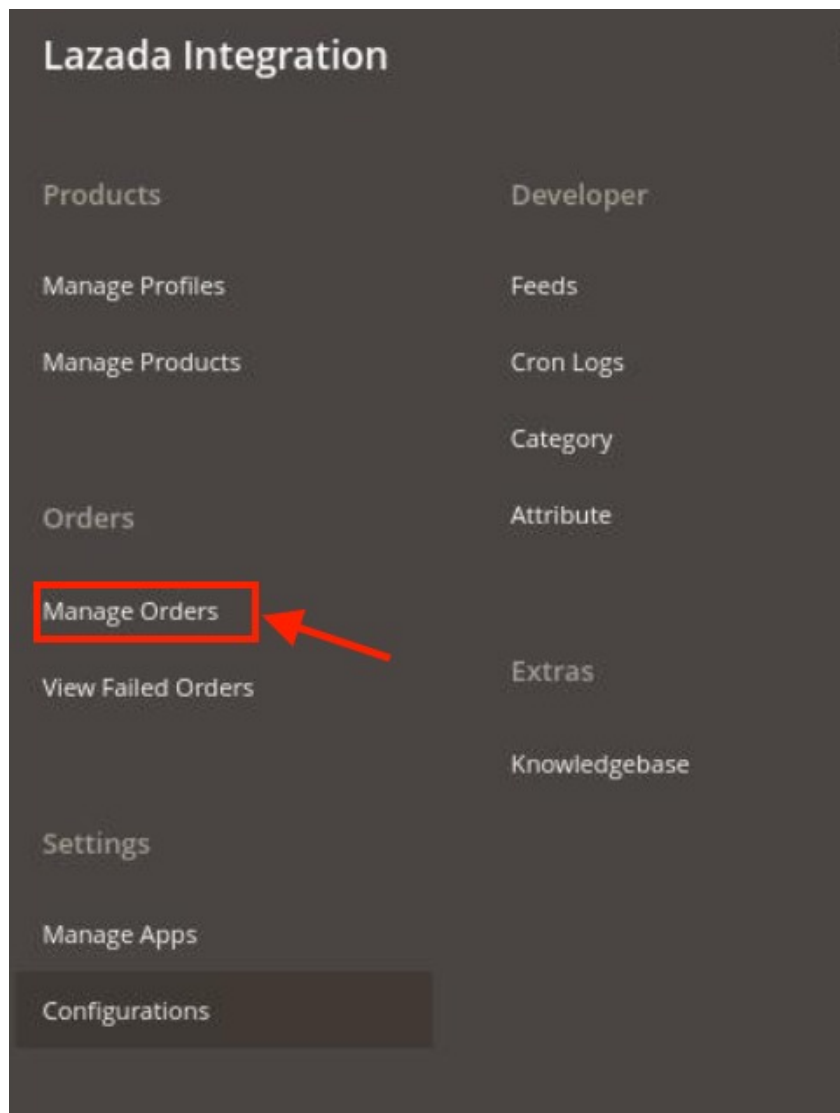

3. Click on **Manage Orders**.  
The **Lazada Order List** page appears as shown in the following figure:

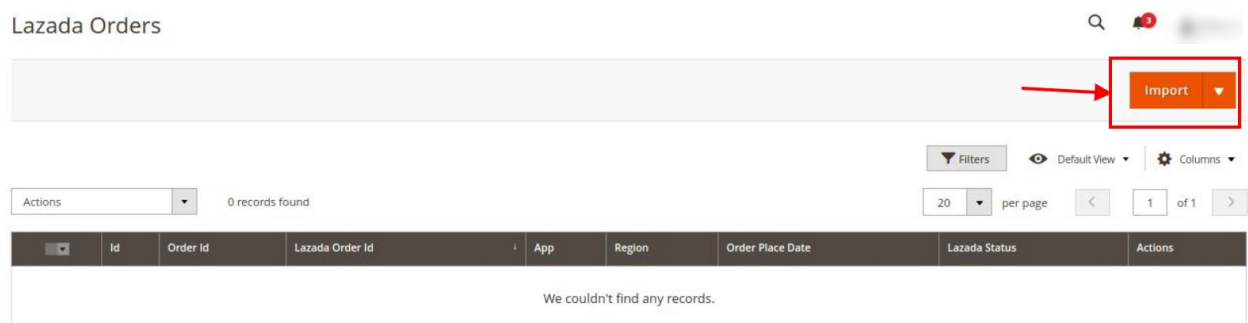

4. Click on the **Import** button.

If the order is imported successfully then, a new record is found in the **Orders Grid** table as shown in the figure.

**Notes:**

- Orders are automatically imported through CRON in every 10 minutes.
- Whenever the latest orders are imported from Lazada, a Notification appears in the notification area of the Admin panel for those orders and they are Auto-Acknowledged as soon as they are imported in the Magento admin panel.
- If no Order is imported, then check the Failed orders listed on the **Lazada Failed Order** page.
- Order are auto rejected on Lazada in the following conditions:
  - When Lazada Product SKU does not exist in Magento.
  - When Product is Out of Stock in Magento.
  - When a product is disabled in Magento.

## 8. Lazada Feeds

After uploading the product on Lazada or after updating the product inventory or the product price, the user can check the status of the feed and sync the selected feeds from the Lazada Feeds page.

**To view and manage the product feeds**

1. Go to **Magento Admin Panel**.
2. On the left navigation bar, click the **LAZADA INTEGRATION** menu.  
A menu appears as shown in the following figure:

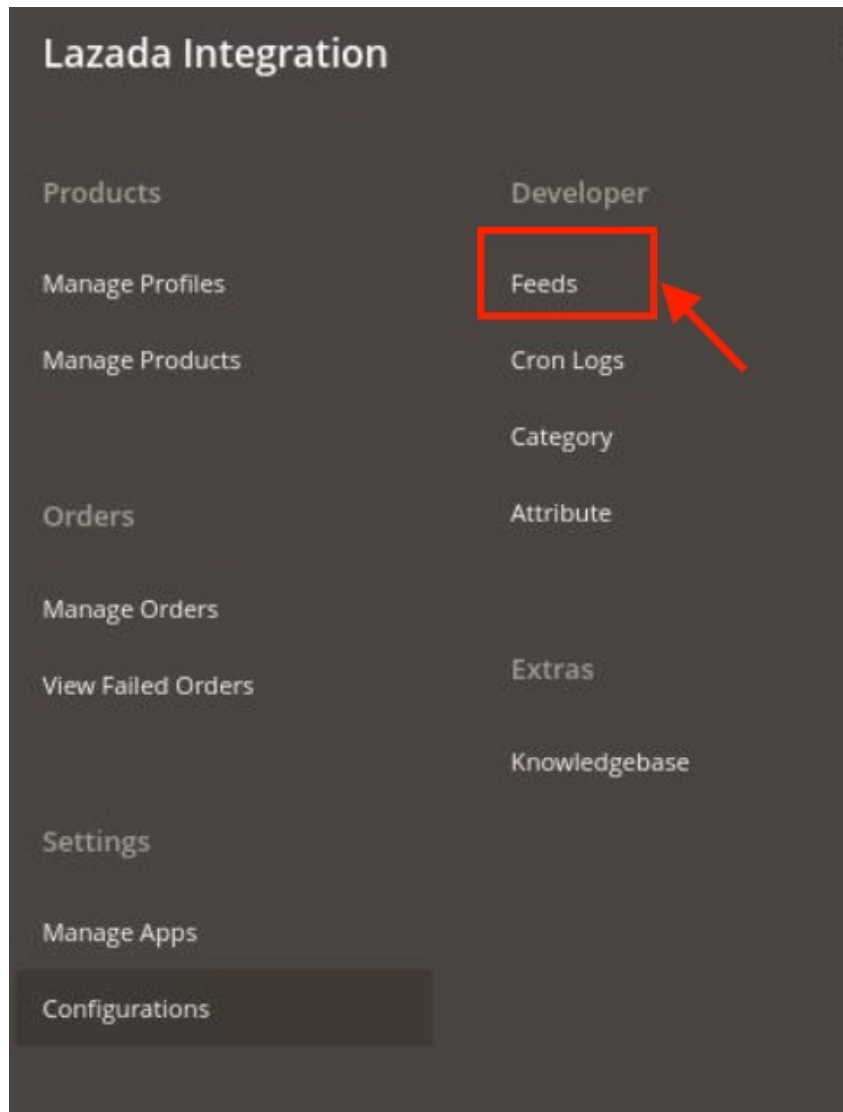

3. Click **Feeds**.

The **Lazada Feeds** page appears as shown in the following figure:

Lazada Feeds

Truncate

Actions

24 records found

20

per page

<

1

of 2

>

<div><div></div></div>	Feed Id	Status	Type	Created Date	Executed Date	Feed File	Response	Actions	Product Ids
<input type="checkbox"/>	0bb6062f15173819114747455e932f	success	CreateProduct	2018-01-31	2018-01-31				
<input type="checkbox"/>	0bb6062f15174899906994020e7e03	success	CreateProduct	2018-02-01	2018-02-01				
<input type="checkbox"/>	0bb606c015174885995803439ec255	success	UpdateProduct	2018-02-01	2018-02-01				
<input type="checkbox"/>	0bb606c015181478907837513ed26e	success	UpdateProduct	2018-02-09	2018-02-09				
<input type="checkbox"/>	0bb606c215173826874365254eb9b5	failure	CreateProduct	2018-01-31	2018-01-31				
<input type="checkbox"/>	0bb606c215174899644161815e6cff	success	RemoveProduct	2018-02-01	2018-02-01				
<input type="checkbox"/>	0bb606c215181479414444116efefa	failure	CreateProduct	2018-02-09	2018-02-09				

4. Do the following tasks if required:

a. View the status of the feed in the **Status** column.

b. To synchronize the specific feed between Lazada and Magento 2, do the following steps:

i. Scroll down to the required row.

ii. In the **Response** column of the respective row, click the **Sync**



icon.

c. To view the **Feed response**, do the following steps:

i. Scroll down to the required row.

ii. In the **Response** column of the respective row, click the **View Feed Response**



icon.

The page appears as shown in the following figure:

Feed Response #0bb6062f15173819114747455e932f



```
{"Body":{"Warnings":[],"Errors":""}}
```

Cancel

d. To view the **Feed File**, do the following steps:

i. Scroll down to the required row.

ii. In the **Feed File** column of the respective row, click the **View Feed file**



icon.

The page appears as shown in the following figure:



Feed #0bb6062f15173819114747455e932f



```

<?xml version="1.0"?>
<Request>
  <Product>
    <PrimaryCategory>10001989</PrimaryCategory>
    <SPUID></SPUID>
    <Attributes>
      <name>Test Product 1</name>
      <short_description><![CDATA[<p>test</p>]]></short_description>
      <brand>Nike</brand>
      <name_ms>Test</name_ms>
    </Attributes>
    <Skus>
      <Sku>
        <color_family>Black</color_family>
        <SellerSku>ChocSedan1</SellerSku>
      </Sku>
    </Skus>
  </Product>
</Request>

```

Cancel

e. To download the **Feed File**, do the following steps:

- i. Scroll down to the required row.
- ii. In the **Feed File** column of the respective row, click the **Download file**



icon.

f. To delete the specific feed, do the following steps:

- i. Scroll down to the required row.
- ii. In the **Actions** column of the respective row, click the **Delete Feed**



icon.

g. To delete the selected feeds, do the following steps:

- i. Select the check boxes associated with the feeds those are no required.
- ii. In the **Action** list, click the **Arrow** button.

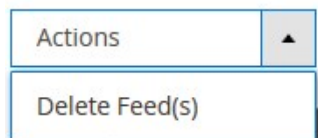

iii. Click **Delete Feeds**.

A confirmation dialog box appears.

iv. Click the **OK** button.

The selected feeds are deleted.

h. To view the *Product Ids* in the specific feed, do the following steps:

- i. Scroll down to the required row.
- ii. In the **Product Ids** column of the respective row, click the **View Product Ids**



icon.

The page appears as shown in the following figure:

Product Ids



["4800"]

[Cancel](#)

## 9. Lazada Cron Details

### *To view Lazada Cron Details*

1. Go to the **Magento 2 Admin** panel.
2. On the left navigation bar, click the **LAZADA INTEGRATION** menu.  
A menu appears as shown in the following figure:

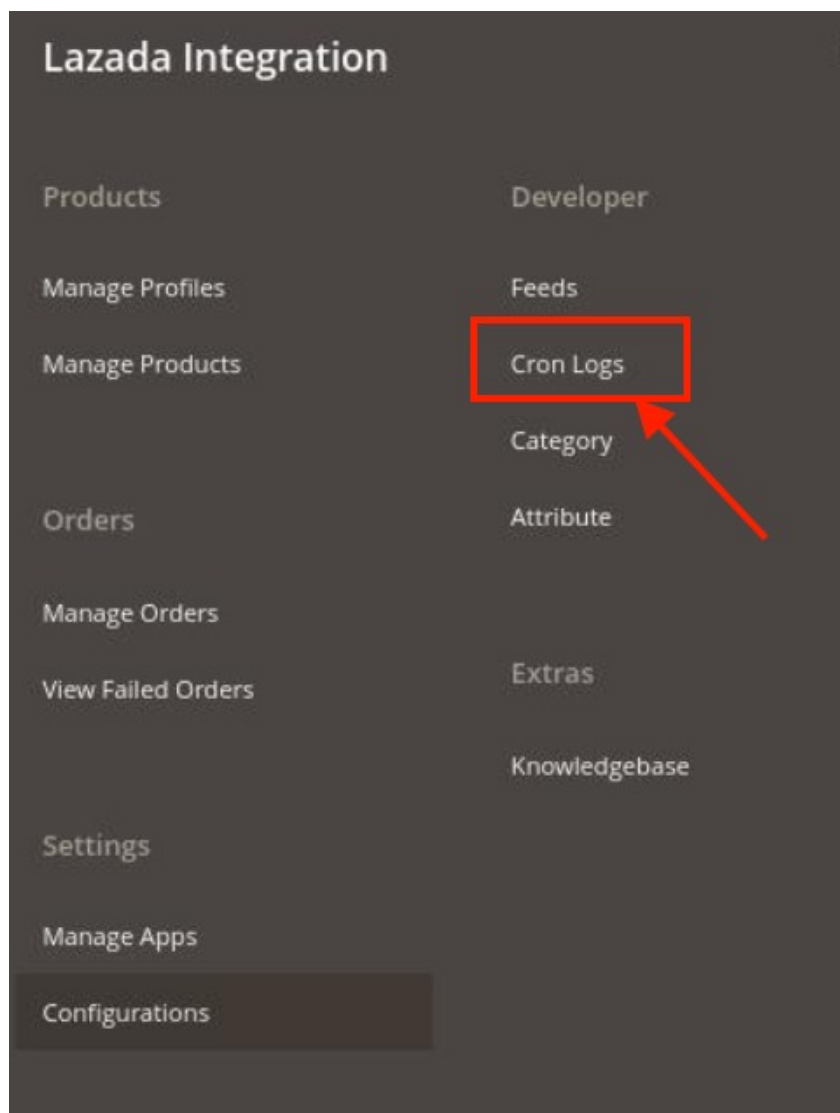

3. Click **Cron Logs**.  
The **Lazada Cron** page appears as shown in the following figure:

## Lazada Crons

   lazada ▾ Truncate Filters Columns ▾

Actions ▾

0 records found

20 ▾

per page

&lt;

1

of 1

&gt;

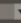
	Id	Job Code	Status	Messages	Created At	Scheduled At	Executed At	Finished At	↓
We couldn't find any records.									

4. The crons will be displayed.

## 10. View Lazada Category Details

### *To view Lazada Category Details*

1. Go to the **Magento 2 Admin** panel.
2. On the left navigation bar, click the **LAZADA INTEGRATION** menu.  
A menu appears as shown in the following figure:

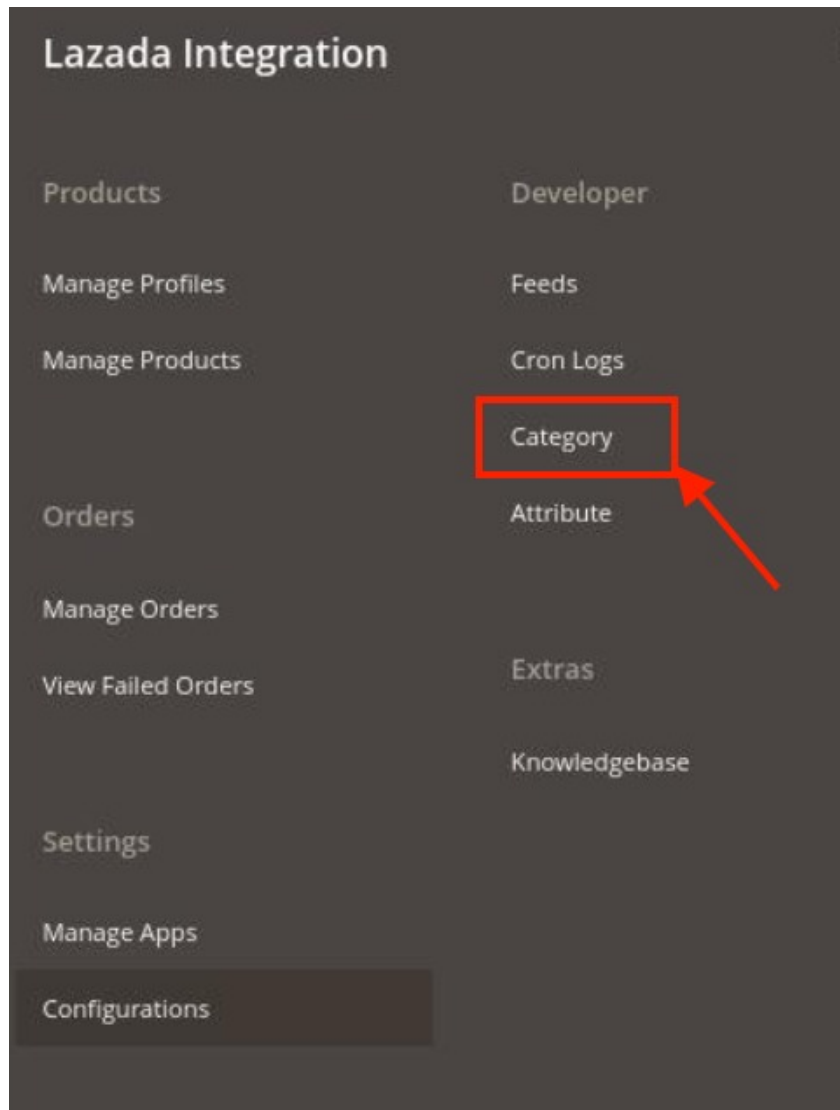

3. Click on **Category**.

The **Lazada Category** page appears as shown in the following figure:

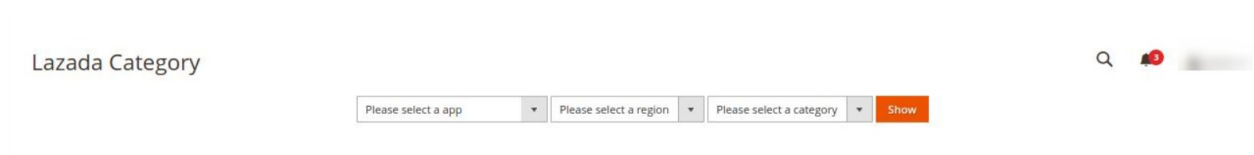

4. Select all the details and click the **Show** button.  
The category details will be displayed.

## 11. View Lazada Category Attributes Details

### *To view Lazada Category Attributes Details*

1. Go to the **Magento 2 Admin** panel.
2. On the left navigation bar, click the **LAZADA INTEGRATION** menu.

A menu appears as shown in the following figure:

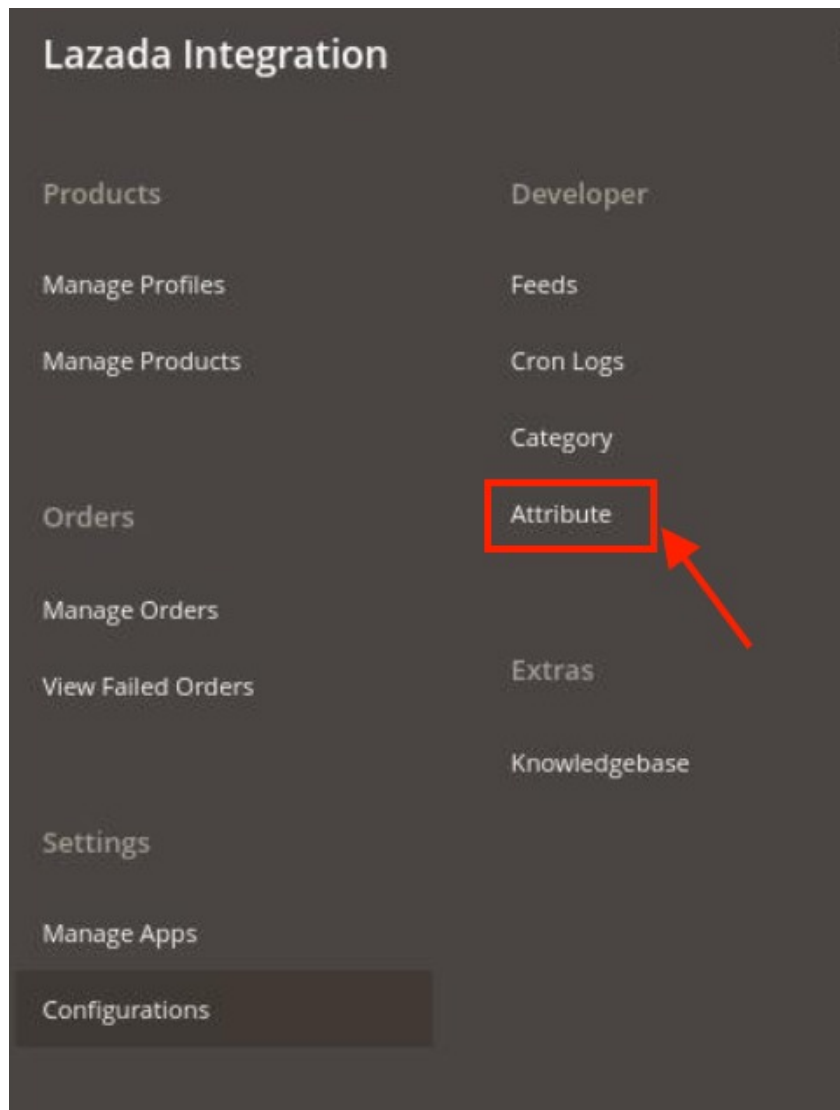

3. Click on **Attribute**.

The **Lazada Category Attributes** page appears as shown in the following figure:

Lazada Category Attributes

4. Select the App, Region, and Category then click the **Show** button.  
The details appear.

## 12. Knowledge base

*To view Knowledgebase*

1. Go to the **Magento 2 Admin** panel.
2. On the left navigation bar, click the **LAZADA INTEGRATION** menu.  
A menu appears as shown in the following figure:

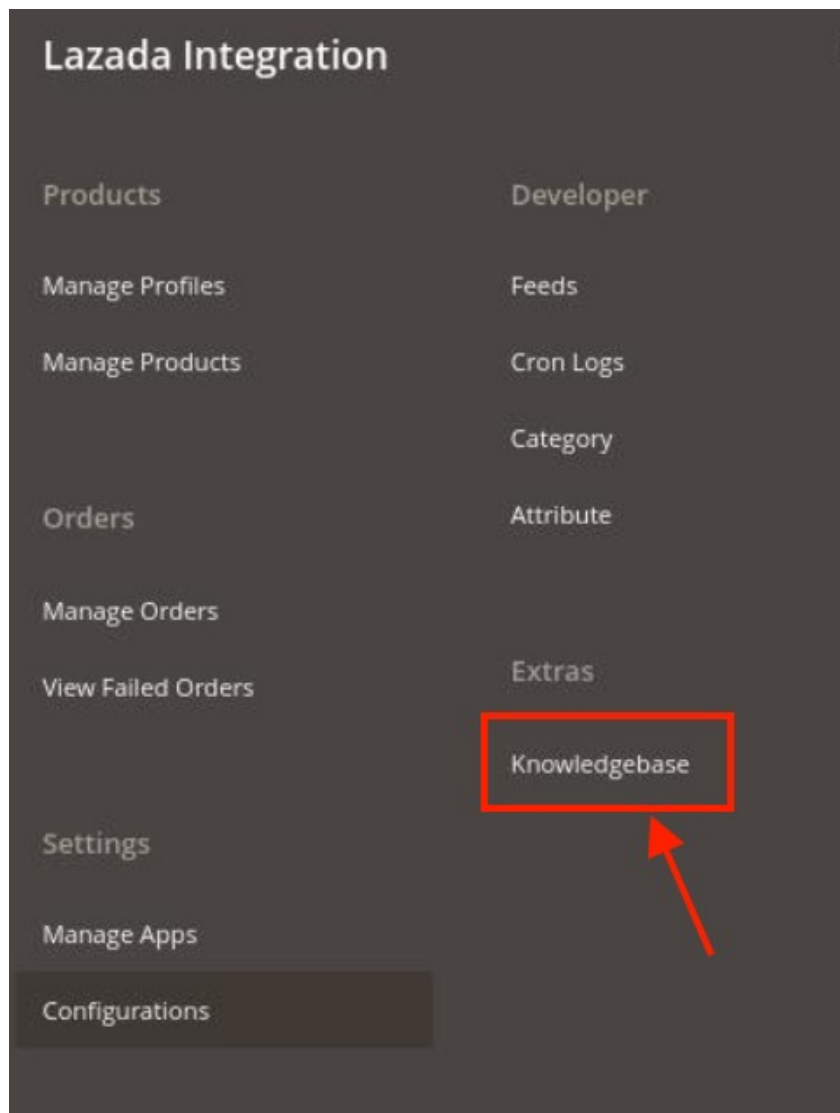

3. Click on **Knowledgebase**, the page appears as shown below:



4. You can go to the Lazada User documentation and developer portal from here.

## 13. Help and Support

*To view Help and Support*

1. Go to the **Magento 2 Admin** panel.
2. On the left navigation bar, click the **LAZADA INTEGRATION** menu.  
A menu appears as shown in the following figure:

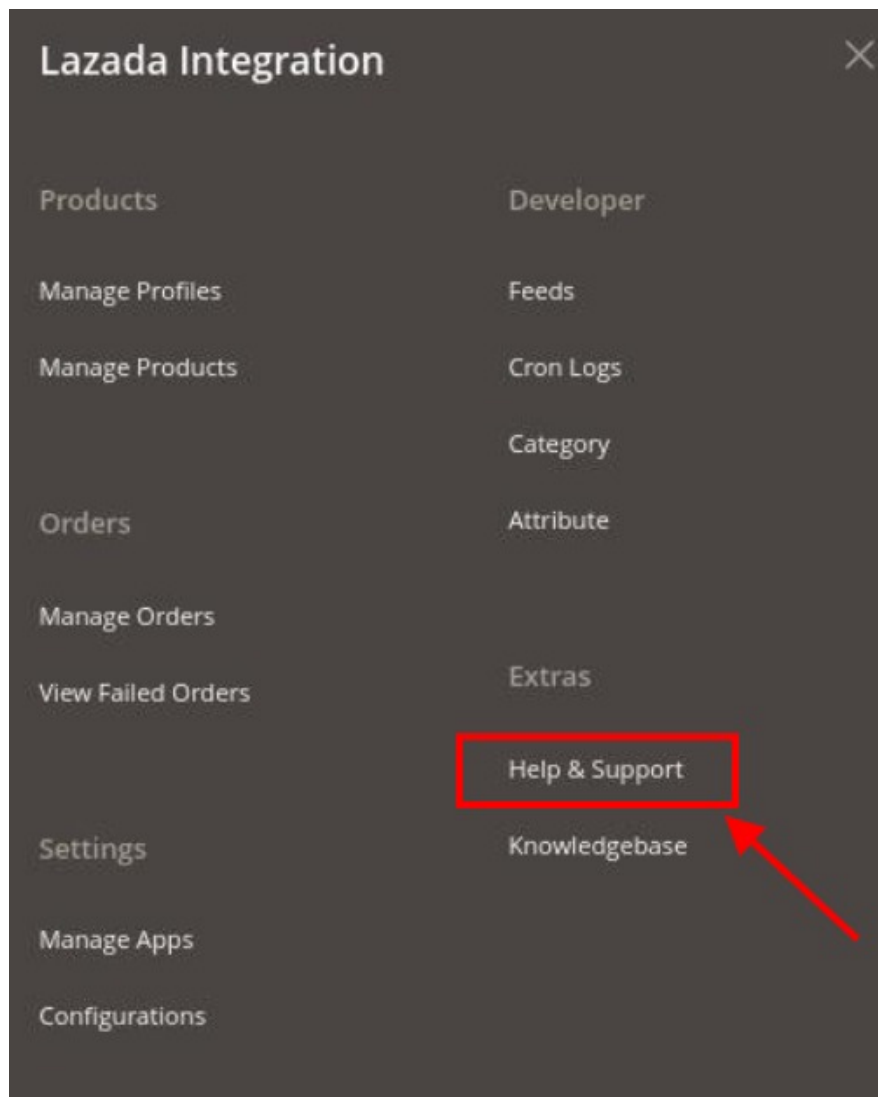

3. Click **Help and Support**.  
The **Lazada Help and Support** page appears as shown in the following:
4. For any queries, you can connect with us via **Call, Email, and Skype**.

Cedcommerce Integrations



Quick Support

